

[www.countyassessor.info](http://www.countyassessor.info)  
**Rogers County Records [OK]**

**Owner Information**  
 LEON HOLDING COMPANY LLC

309 1ST AVE E  
 KALISPELL, MT 59901-0000

**Property Address**  
 25605 S HWY 66

**Building No.** 849      **Account Number** 660001124

**Sub Name:** 20N-15E  
 Lot: 0      Block: 0

**Area Name:** UNPLATTED TWP-RNG  
 Section 2      Township: 20N      Range: 15E

Taxable Market		Assessed Value
Land	\$425000	\$46750
Improved	\$0	\$0
Mobile	\$0	\$0
<b>Total</b>	<b>\$425000</b>	<b>\$46750</b>
	Exemptions	\$0
School District 80	Net Assessed	\$46750
School Levy \$93.59	Estimated Taxes	<b>\$4375.42</b>

**Sales Information**

Sale Date	Sale Price	Book/Page	\$/SF
20211202	425000	2021/023204	0
Grantor: NESBITT, DOUGLAS A &			
Sale Date	Sale Price	Book/Page	\$/SF
19980401	90000	1105/446	0
Grantor: SHELBY, JAMES MICHAEL			
Sale Date	Sale Price	Book/Page	\$/SF
19950731	0	997/122	0
Grantor: SHELBY, MARY ANN			

**Building Elements**

Type	N/A
Style	N/A
Design	N/A
Quality	1
Condition	Worn Out
Roof	N/A
Exterior Wall	N/A
Foundation	N/A
Heat	N/A
Beds	0
Garage	N/A
Porch	N/A
Basement	N/A
Year Built	0
Square Footage	0

Interior Finish	N/A
Fireplace	N/A
Air	N/A
Total Rooms	0
Garage SF	0
Porch SF	0
Basement SF	0
Year Remodeled	0
Eff Year Built	0

**Land Information**

Land Use: URBAN COM

Lots	Acres	SF	Width	depth
0	5.71	0	0	0

Description Acres

**Mobile Home Information**

Serial No.  
 Make  
 Tag No.      LxW x

**Commercial Elements**

Stories	N/A
Units	0
Class Description	N/A
Story Height	00
Rent	000
Perimeter	0000

**Miscellaneous Structures**

Description	Yrblt	LxW	Units
N/A	0		0
N/A	0		0
N/A	0		0
N/A	0		0
N/A	0		0
N/A	0		0
N/A	0		0
N/A	0		0
N/A	0		0
N/A	0		0
N/A	0		0

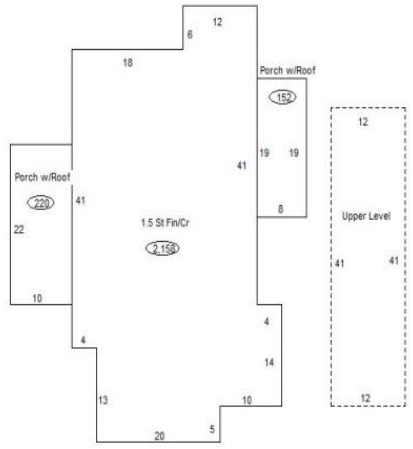

**Legal Description**

SE NE S & E RY LESS .75 AC WATER/L & LESS 2.06 AC HY LESS 5.01 NEW HY LESS TR BEG: SE/C SE SE NE, N 247.95', N 47-28 W 175.10' S 42-31 W 117.75', S 279.32', E 208.7' TO POB & LESS TR BEG 20'